

# Installation Instructions - EasyFit Edge3.5 Flange

For Edge3.5 Fixed, Adjustable and Wallwash Flange

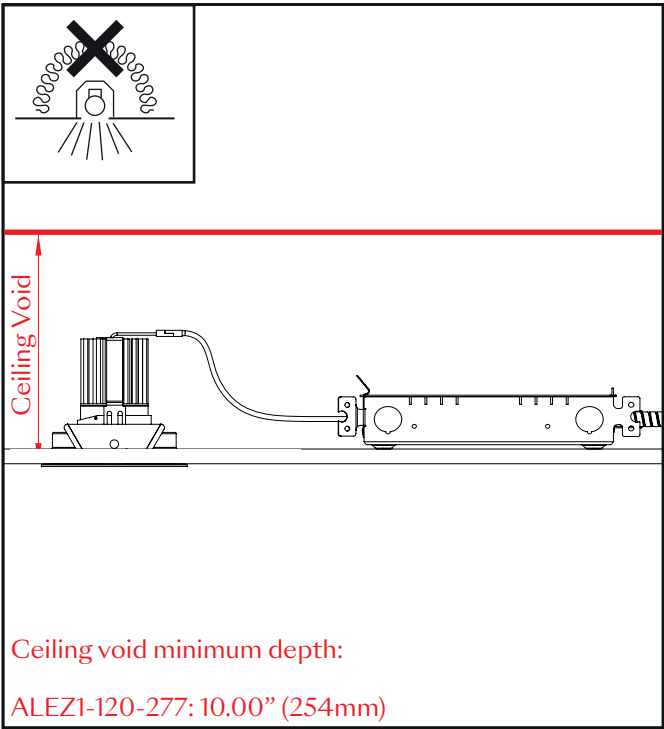

Do not cover any element of the installation with insulation material.

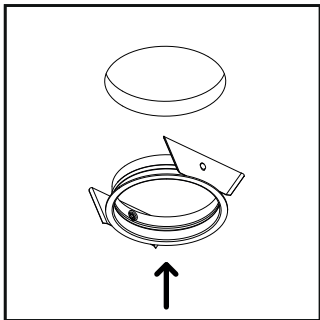
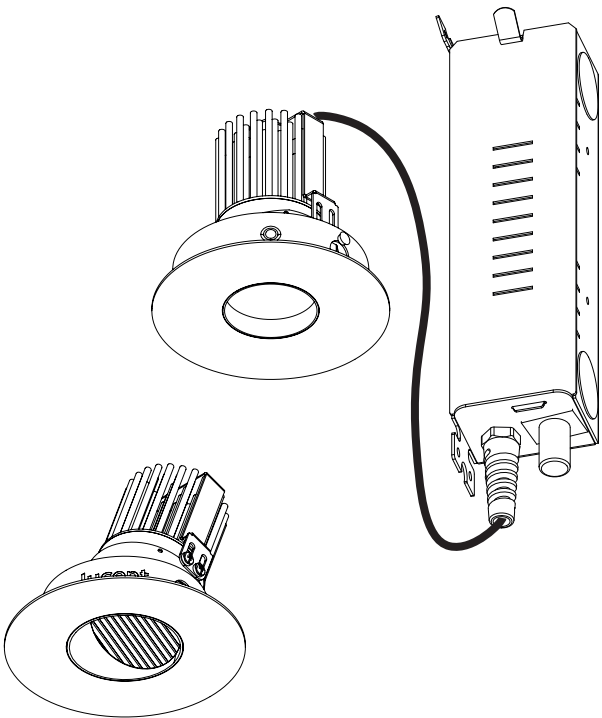

1. Cut out hole in ceiling and insert installation kit.  
Cutout size- Ø3.27" (Ø83mm)

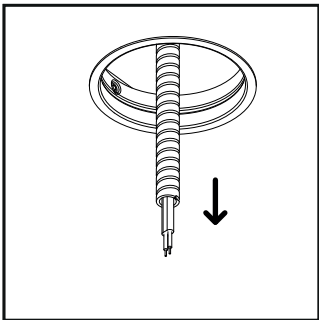

2. Bring through main power connection

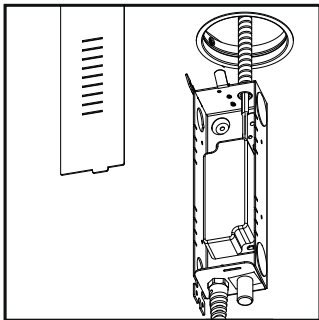

3. Remove Lid on Easyfit box to access driver. Connect driver to mains power.

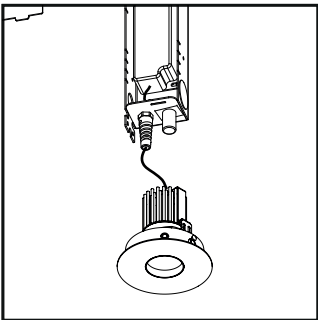

4. Make connection with driver.

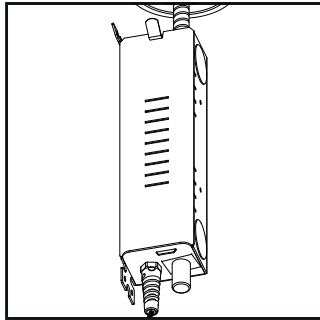

5. Replace lid on Easyfit box.

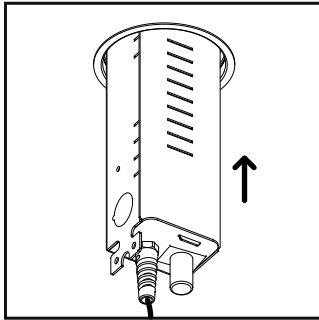

6. Pass Easyfit box through installation kit.

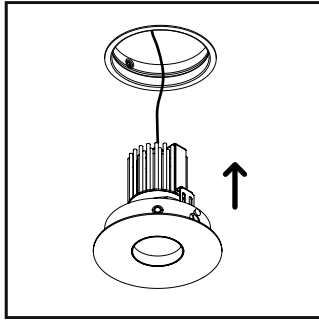

7. Insert fitting into installation kit.

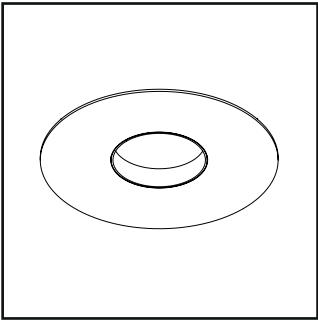

8. Finished installation.